

Suspension Arm Pin

optionally electrified,
with 3-pole sliding contact

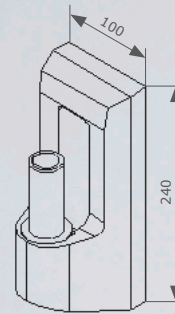

PORTEGRA²

Models:	TS1515	Wall mounting for Portegra2 suspension arm, max. load 13.0 kg / 28.6 lbs (end of spring arm)
	TS1515R	Wall mounting for Portegra2, with reinforced base plate, max. load 15.0 kg / 33.1 lbs
	TS1515E	Wall mounting for Portegra2, with electrified pin, max. load 13.0 kg / 28.6 lbs

Made in Germany

IEC 60601-1

TS1515 – Wall Mounting for Portegra2 Suspension Arm

MAVIG has set a standard for practices and hospitals in ceiling support and radiation protective systems.

In situations where installing a ceiling column is not an option, MAVIG offers a second possibility with the wall mount for Portegra2. Just like the ceiling suspension systems, the wall mount allows the user to conveniently free up floor space for other medical devices without large investment.

- **Single mounting pin for suspension arm support, optionally electrified**
- **Easy installation**
- **Electrification:** Cable cut-out for external cabling (*TS1515 and TS1515R*), or Pin electrified, with 3-pole sliding contact (*TS1515E*)
- **Max. load capacity: (end of suspension arm)**
 - 13.0 kg / 28.6 lbs for 750 mm extension arm, or
 - 15.0 kg / 33.1 lbs for 750 mm extension arm (*only TS1515R*)
 - 10.0 kg / 22.0 lbs for 950 mm extension arm, or
 - 13.0 kg / 28.6 lbs for 950 mm extension arm (*only TS1515R*)

MAVIG GmbH

X-Ray Protection and Medical
Suspension Systems
Stahlgruberring 5
81829 Munich
Germany
PO Box 82 03 62
81803 Munich
Germany
Phone +49 (0) 89 / 420 96 - 0
Fax: + 49 (0) 89 / 420 96 -
200 e-Mail info@mavig.com
www.mavig.com

ТОВ „ОНКОМЕДИКА“
Уповноважений
представник в Україні
01014, Україна, м. Київ, вул.
Звіринецька, 63
+38 (044) 228 84 17
+38 (097) 959 10 89
info@oncomedica.ua
www.oncomedica.ua
www.mavig.com.ua