

Curved Support

for two monitors, with handle

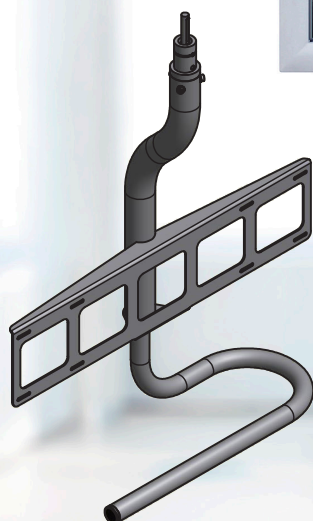

GD4220 Rear view

Article-No.:	GD4220	Monitor support for two displays up to 19", with VESA 100 adapter
	GD4220-L	Monitor support for two displays up to 21"/24", with VESA 100 adapter
	GD4220-XL	Monitor support for two displays up to 24"/26", with VESA 100 adapter

Made in Germany

GD4220 – Dual Monitor Support* for Portegra2 Systems

The GD4220 can easily hold up to two 26" monitors (depending on version). The large curved handlebar protects the monitor and provides a means for quick & easy positioning. Combined with the mobility and safety of the Portegra2 suspension arm, the GD4220 offers the user a worry-free and flexible application.

- **Application** Monitor support with handle, VESA 100 adapter for two displays, external cabling
- **Load / Weight**

GD4220	max. 15.0 kg (33 lbs) / 3.0 kg
GD4220-L	max. 14.5 kg (32 lbs) / 3.5 kg
GD4220-XL	max. 14.2 kg (31 lbs) / 3.8 kg
- **VESA adapter** VESA 100 compatible
- **Colouring** RAL9002
- **Mounting** Portegra2 systems for Stationary / ceiling track mounting
- **System range** Extension arm 750 mm / 950 mm
Spring arm 910 mm

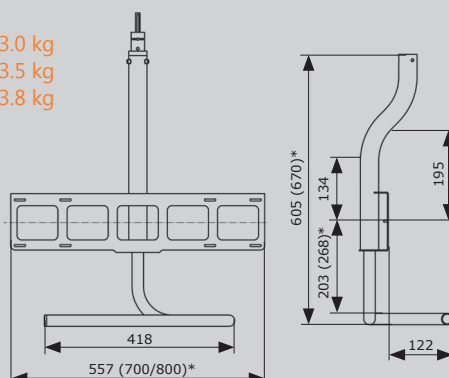

* Monitor support without extension / spring arm, cabling and monitor(s).

* (Dimensions for L and XL versions)

MAVIG GmbH

X-Ray Protection and Medical Suspension Systems
 Stahlgruberring 5
 81829 Munich
 Germany
 PO Box 82 03 62
 81803 Munich
 Germany
 Phone +49 (0) 89 / 420 96 - 0
 Fax: + 49 (0) 89 / 420 96 - 200
 e-Mail info@mavig.com
 www.mavig.com
ТОВ „ОНКОМЕДИКА“
Уповноважений
представник в Україні
 01014, Україна, м. Київ, вул.
 Звіринецька, 63
 +38 (044) 228 84 17
 +38 (097) 959 10 89
 info@oncomedica.ua
 www.oncomedica.ua
 www.mavig.com.ua